

**ORDINANCE NO. 2022-010**

**AN ORDINANCE OF THE TOWN OF SOUTHWEST RANCHES, FLORIDA REDISTRICTING THE TOWN IN ACCORDANCE WITH SECTION 2.04 (b) OF THE TOWN'S CHARTER TO INCORPORATE THE RESULTS OF THE 2020 CENSUS; REPEALING ORDINANCE NO. 2011-14 BY ESTABLISHING AND ADOPTING FOUR (4) REVISED RESIDENTIAL ELECTION DISTRICTS PRIOR TO THE QUALIFYING PERIOD FOR THE MUNICIPAL ELECTION OF 2022; PROVIDING FOR CONFLICTS; PROVIDING FOR SEVERABILITY; PROVIDING FOR INCLUSION IN THE TOWN'S CODE; AND PROVIDING AN EFFECTIVE DATE.**

**WHEREAS**, Section 2.04 (b) of the Town's Charter provides for the Town to be broken into four (4) residential districts, which shall be as nearly equal in population as practicable; and

**WHEREAS**, these four (4) residential districts are to be reviewed and possibly redrawn based upon the results of the decennial census; and

**WHEREAS**, as a result of the 2000 census, on June 14, 2001, the Town adopted its first residential districts pursuant to Resolution No. 2001-70; and

**WHEREAS**, as a result of the 2010 census, on September 22, 2011, the Town amended the four residential districts pursuant to Ordinance 2011-014; and

**WHEREAS**, pursuant to an approved agreement with Scott Burton-Rodriguez, d/b/a Empire Consultants for consulting services relating to the review and the analysis of the 2020 census data and the Town's four residential election districts, presentations and a discussion of options were debated by the Town Council at the February 24, March 24, and April 14, 2022 Town Council Meetings; and

**WHEREAS**, after an extensive review of the consultant's analysis and findings, all at publicly noticed meetings, the Town Council carefully considered seven possible redistricting scenarios in response to the population changes in the Town; and

**WHEREAS**, after carefully examining the seven possible redistricting scenarios, the Town Council finds that Scenario 4A, attached hereto as Exhibit "A" and incorporated herein by reference, divides the Town into four compact residential election districts as nearly equal in population as practicable, and is in the best interest of the health, safety, and welfare of the Town.

**NOW, THEREFORE, BE IT ORDAINED BY THE TOWN OF SOUTHWEST RANCHES FLORIDA:**

**Section 1: Recitals.** The above recitals above are true and correct and are incorporated herein by reference.

**Section 2:** In accordance with Section 2.04 (b) of the Town's Charter, following an extensive review of the 2020 census data, and a complete review of the Town's population changes, and residential election district options, the Town Council hereby selects Scenario 4A, as attached hereto and incorporated herein by reference as Exhibit "A", to represent the defined boundaries of the four residential election districts of the Town.

**Section 3:** The Town hereby repeals Ordinance No. 2011-14, and establishes four newly revised election districts, which have been created prior to the qualifying period for the municipal election of 2022.

**Section 4: Conflicts.** All Ordinances or parts of Ordinances, Resolutions or parts of Resolutions in conflict herewith, be and the same are hereby repealed to the extent of such conflict.

**Section 5: Severability.** If any portion of this Ordinance is determined by any Court to be invalid, the invalid portion shall be stricken, and such striking shall not affect the validity of the remainder of this Ordinance. If any Court determines that this Ordinance, or any portion hereof, cannot be legally applied to any individual(s), group(s), entity(ies), property(ies), or circumstance(s), such determination shall not affect the applicability hereof to any other individual, group, entity, property or circumstance.

**Section 6: Inclusion in Code.** It is the intention of the Town Council that the provisions of this Ordinance shall become and be made a part of the Town of Southwest Ranches Code; and that the sections of this Ordinance may be renumbered or relettered and the word "ordinance" may be changed to "section," "article," or such other appropriate word or phrase in order to accomplish such intentions.

**Section 7: Effective Date.** This Ordinance shall be effective immediately upon its adoption.

**[Signatures on Next Page]**

**PASSED ON FIRST READING** this 28<sup>th</sup> day of April, 2022 on a motion made by Council Member Kuczenski and seconded by Council Member Hartmann.

**PASSED AND ADOPTED ON SECOND READING** this 12<sup>th</sup> day of May, 2022 on a motion made by Cm Kuczenski and seconded by Cm Allbritton.

Breitkreuz	<u>yes</u>	Ayes	<u>5</u>
Jablonski	<u>yes</u>	Nays	<u>0</u>
Allbritton	<u>yes</u>	Absent	<u>0</u>
Hartmann	<u>yes</u>	Abstaining	<u>0</u>
Kuczenski	<u>yes</u>		

  
Steve Breitkreuz, Mayor

Attest:   
Russell Muniz, Assistant Town Administrator/Town Clerk

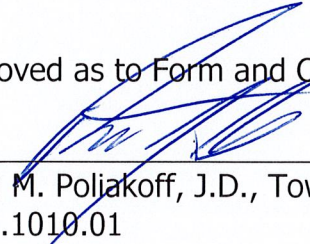
Approved as to Form and Correctness:  Pol:  
Keith M. Poljakoff, J.D., Town Attorney  
1001.1010.01



**EXHIBIT A**

# PLAN 04-A

## Boundary Configuration

Assessment Summary

# PLAN 4-A

## Town Council District Boundary Configuration

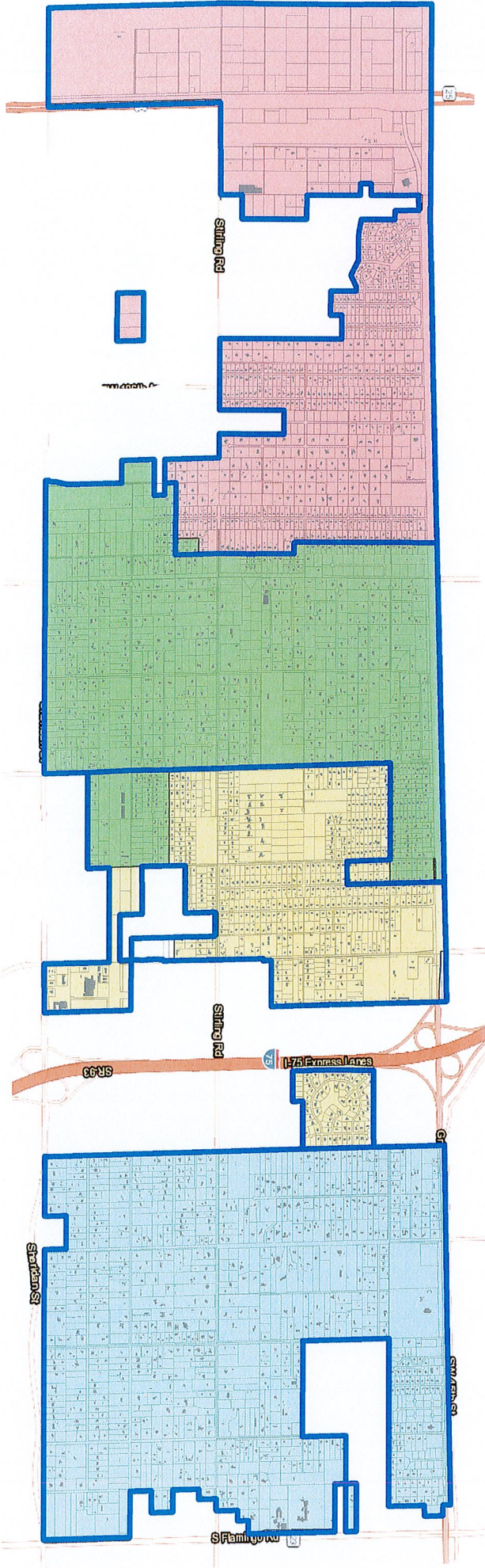

PLAN 04-A			
District	Population	Diff <sup>3</sup>	Pct <sup>4</sup>
District 1	2,062	81	4.1%
District 2	1,948	(33)	-1.7%
District 3	1,976	(5)	-0.2%
District 4	1,937	(44)	-2.2%
<b>TOTAL</b>	<b>7,973</b>	<b>235</b>	
<b>Ideal Population (Mean)<sup>1</sup></b>	<b>1,981</b>		
<b>Percent Deviation from Mean<sup>2</sup></b>	<b>3.0%</b>		

**Legend**

- Existing Council Districts
- District D1
- District D2
- District D3
- District D4



# Assessment Summary | Plan 04-A

- **PLAN 04-A**
- Minimize modifications to existing district boundaries, while attempting to balance population equality per District, Contiguity, and Compactness while not splitting communities of interest.
- Based on Existing Districts, small portion of the *southeastern* section of **District 1** (Census Block 3011, 27 persons) is assigned to **District 2**
- Based on Existing Districts, portion of the *northeast* portion of **District 2** (Census Block 1009, 41 persons) is assigned to **District 3**
- **District 4** stay intact to the existing district boundary configuration
- **District 1** improves population equality with a deviation of 4.1% (81 persons over the ideal district population of 1,981 per District.) The existing **District 1** population deviation is 5.5% (108 people over ideal population of 1,981).
- **District 2** improves population equality with a deviation of -1.7% (33 persons less than ideal population). The existing boundaries of **District 2** population deviation is -6.7% (133 people less than ideal population of 1,981).
- **District 3** improves population equality with a deviation of -0.2% (5 persons less than ideal population). The existing boundaries of **District 3** population has a deviation of 3.4% (68 persons over the ideal population)
- **District 4** population equality remains the same since the district boundaries were not changed as the deviation falls within +/-5%, with a deviation of -2.2% (44 persons less than the ideal population).

PLAN 04-A			
District	Population	Diff <sup>3</sup>	Pct <sup>4</sup>
District 1	2,062	81	4.1%
District 2	1,948	(33)	-1.7%
District 3	1,976	(5)	-0.2%
District 4	1,937	(44)	-2.2%
<b>TOTAL</b>	<b>7,923</b>	<b>235</b>	
<b>Ideal Population (Mean)<sup>1</sup></b>	<b>1,981</b>		
<b>Percent Deviation from Mean<sup>2</sup></b>	<b>3.0%</b>		

